

| REVISIONS | | | |
|-----------|----------------|------------|-----------|
| REV | DESCRIPTION | DATE | APPROVED |
| 1 | INITIAL SKETCH | 2012-11-14 | J. DEMERS |

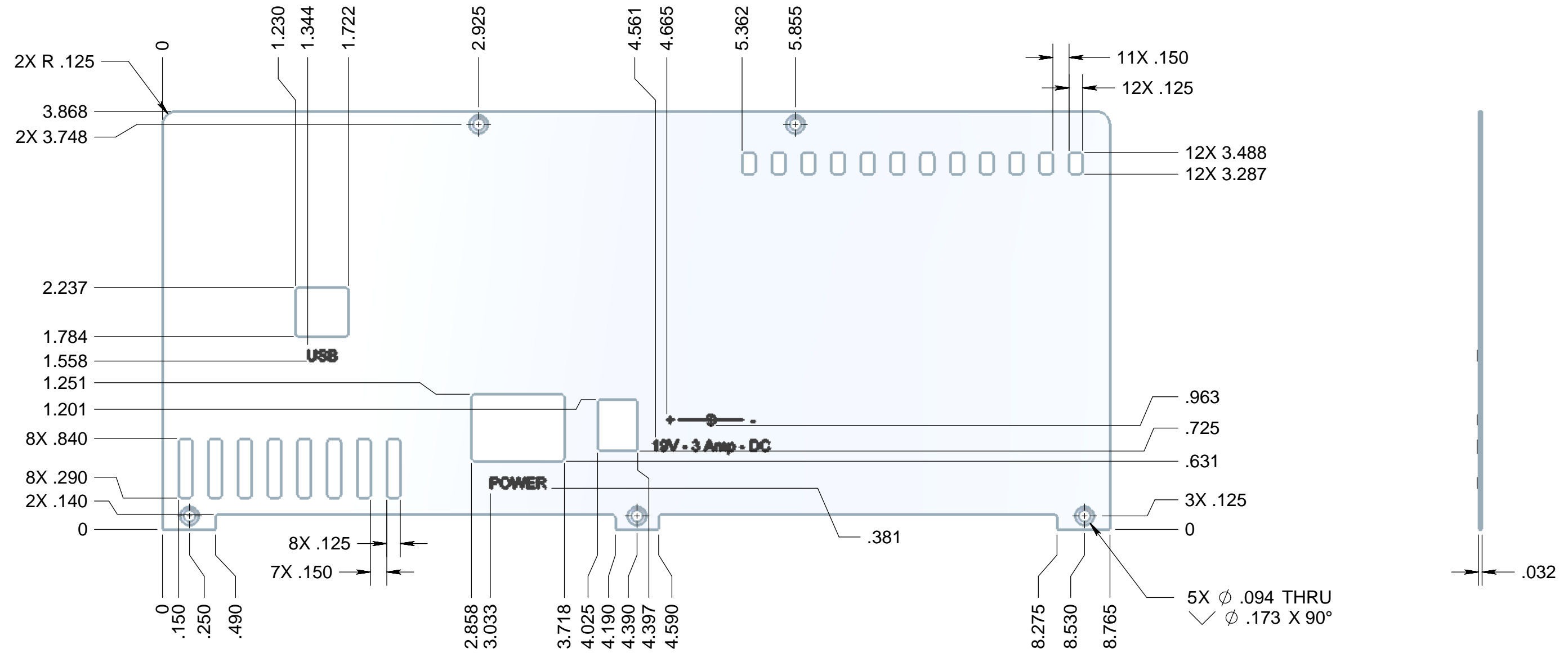

NOTES: UNLESS OTHERWISE SPECIFIED

- 1 MATERIAL: 6061-T6 ALUMINUM OR EQUIVALENT
- 2 FINISH: TRIVALENT CHROMIUM COAT WITH SERTEC 650-CHROMITAL TCP, CORROSION LEVEL III PER ASTM-B117, COLOR: CLEAR, APPEARANCE: BRIGHT. OPTIONAL FINISH: CHEMICAL CONVERSION PER MIL-DTL-81706, TYPE II, CLASS 3, COLOR: CLEAR.
3. INSIDE FILLETS: R .032, UNLESS OTHERWISE SPECIFIED
4. TEXT: SILK SCREEN AS NOTED
FONT: ARIAL
SIZE: 10 PT
COLOR: BLACK
5. ALL MATERIALS REQUIRED TO BE RoHS AND WEEE COMPLIANT PER EUROPEAN DIRECTIVES 2002/95/EC AND 2002/96/EC INCLUDING ALL AMENDMENTS AND COMMISSION DECISIONS MADE THEREAFTER.

UNLESS OTHERWISE SPECIFIED
DIMENSIONS ARE IN INCHES
TOLERANCES ARE:

ANGLES $\pm 5^\circ$
.XX = $\pm .010$
.XXX = $\pm .005$

DRAWING GENERATED USING
SOLIDWORKS

| APPROVED | DATE |
|---------------------------|------------|
| DESIGNED BY: J. DEMERS | 2012-11-09 |
| DRAWN BY: S. CISNEROS | 2012-11-13 |
| CHECKED BY: J. DEMERS | 2012-11-14 |
| APPROVED BY: J. DEMERS | 2012-11-14 |

THIRD ANGLE OF PROJECTION

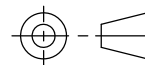

| TITLE | | | |
|---------------------------|-------------|----------------------|----------|
| PB7200 FRONT PLATE | | | |
| SIZE | SCALE: | DWG NO. | REV |
| B | NONE | G7914-080-002 | 1 |
| SHEET | | | 1 OF 1 |